



## Apartment 115 The Gate, 21 Aspin Lane

, Salford, M4 4GT

**Offers Over £290,000**

This fantastic apartment has remained vacant since the development was completed and offers a bright and stylish interior with impressive views over Angel Meadow Park from its twelfth floor position. The stylish property is presented to the standard of a show apartment and forms part of the Meadowside complex, a cluster of purpose built developments overlooking the largest green space the city has to offer. The Gate is one of four buildings each with their own slick glass façade designed to complement and reflect the rich colours and materials of the surrounding Victorian and industrial architecture. There is a residents lounge, gym, wellness room & shared terrace in the neighbouring block, The Stile, as well as a 24 hour concierge service, and bike storage area. The development also falls within the NOMA district on the northern edge of the city and is a short walk from Victoria train station, Northern Quarter and the city's main retail district. The spacious accommodation briefly comprises; open plan living room with floor to ceiling window, fully fitted kitchen with solid surface work top, integrated appliances and handle free doors with soft closing hinges, two spacious carpeted double bedrooms each with floor to ceiling windows and built in wardrobes, luxury en suite shower room with a walk in shower behind a toughened glazed opening door and an impressive bathroom suite with a contemporary white steel enamel bath with wall fixed rain shower head and hinged fitted glass shower screen. No onward chain. EPC rating (B)

- Stunning Two Bedroom Apartment
- Twelfth Floor Position
- Luxury Bathroom + En Suite Shower Room
- 24 Hour Concierge Service
- Residents Lounge, Gym, Wellness Room & Shared Terrace
- Short Walk from Victoria Train Station & Metrolink
- Bright & Spacious Accommodation with Floor to Ceiling Windows
- Impressive Glass Fronted Development Overlooking Angel Meadows Park
- Close to Northern Quarter & Main Retail District
- No Onward Chain

Please contact our Kaytons Estate Agents Office on 0161 672 1144

if you wish to arrange a viewing appointment for this property or require further information



2



2



1



B



Floor Plan

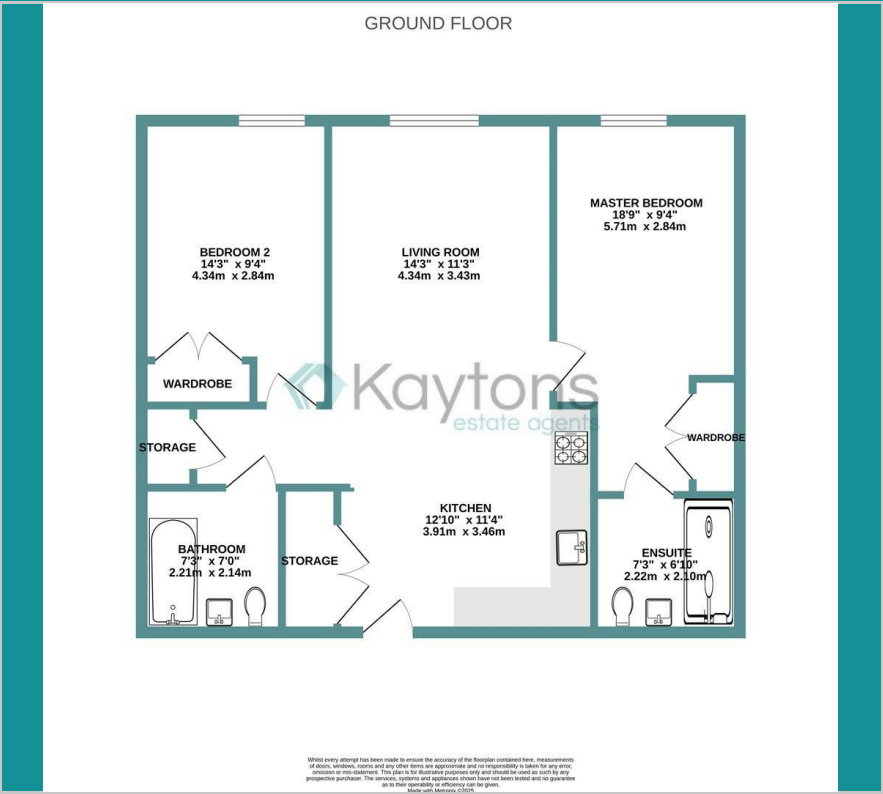

Area Map



Energy Efficiency Graph

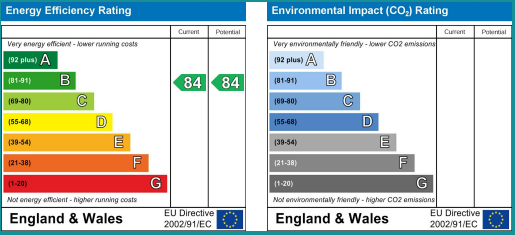

These particulars, whilst believed to be accurate are set out as a general outline only for guidance and do not constitute any part of an offer or contract. Intending purchasers should not rely on them as statements of representation of fact, but must satisfy themselves by inspection or otherwise as to their accuracy. No person in this firms employment has the authority to make or give any representation or warranty in respect of the property.